



# Manhole Covers Ireland

**We cover everything!**

**Lowpark, Charlestown, Co. Mayo, Ireland.**

Phone 094 9033 022 Fax 094 92 54970

Email: [info@mhcireland.com](mailto:info@mhcireland.com) web Site [www.mhcireland.com](http://www.mhcireland.com)

## **D400 & C250 Recessed Pavior Cover & Frame**

### **D400 Recessed Covers & Frame**

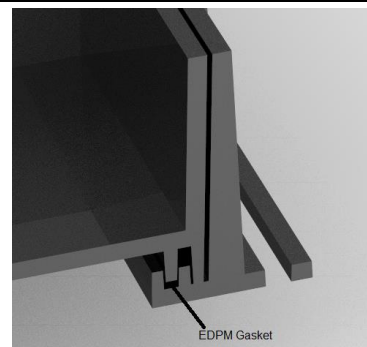

**CROSS Section showing the watertight Seal**

**Group 4**

Road carriageways (including pedestrian streets), hard shoulders and parking areas for all types of road vehicles.  
EN124 D400

Product Code	Clear Opening	Overall Size	Frame Height	Internal Tray Depth
MH-D-CRDS40	300 x 300mm	415 x 415mm	100mm	70mm
MH-D-CRDS55	450 x 450mm	565 x 565mm	100mm	70mm
MH-D-CRDS70	600 x 600mm	715 x 715mm	100mm	70mm
MH-D-CRD60120	600 x 1200mm	760 x 1350mm	100mm	70mm
MH-D-CRDS85	750 x 750mm	870 x 870mm	100mm	70mm

### **C250 Recessed Covers & Frame**

Product Code	Clear Opening	Overall Size	Frame Height	Internal Tray Depth
CRCS40	300 x 300mm	415 x 415mm	100mm	70mm
CRCS55	450 x 450mm	565 x 565mm	100mm	70mm
CRCS70	600 x 600mm	715 x 715mm	100mm	70mm
CRCS60110	900 x 450mm	1100 x 600mm	100mm	70mm
CRC60120	600 x 1200mm	760 x 1350mm	100mm	70mm

#### **Frame**

It is obtained from a single cast, its stability is guaranteed through a double throat supporting area, creating a metal to metal coupling thanks to the interposition of an EPDM gasket making the cover and frame doubled sealed, this is studied to obtain a Watertight sealing. (Correct installation is essential). A grease seal can also be added.

#### **Cover**

It is square in shape, it ensures a high stability due to the depth of insertion over 50 mm, the EPDM gasket inserted in the throat, which is located in the supporting area, and the locking system with stainless steel screws. The opening process is obtained through the insertion of specific handles in the blind holes of the surface. The filling basin has a height of 70 mm and it can host any kind of filling material. All the covers are interchangeable.

#### **Intended use**

**D400** It is designed for footpaths and parking areas and for all types of road vehicles (see Norm EN 124 group 4).

**C250** for manhole covers and gullies for drain wells, installed in water run off areas along the side of pavements. The distance measured from the edge of the pavement extends by 0.5 m in the carriageway and for a maximum of 0.2 m on the pavement (see norm EN124 group 3). All product are made to EN124 and are 3<sup>rd</sup> party Certified. (Copy available)

#### **Treatment**

The manhole cover presents a standard black protective coating